

## ENHANCED COMFORT

### Optional silent modes

XMVF VRF has optional silent modes including night silent mode and non-night silent mode which provides more freedom and convenience to match the customers' needs. Different silent mode is achieved by setting up field settings or through the centralized controller.

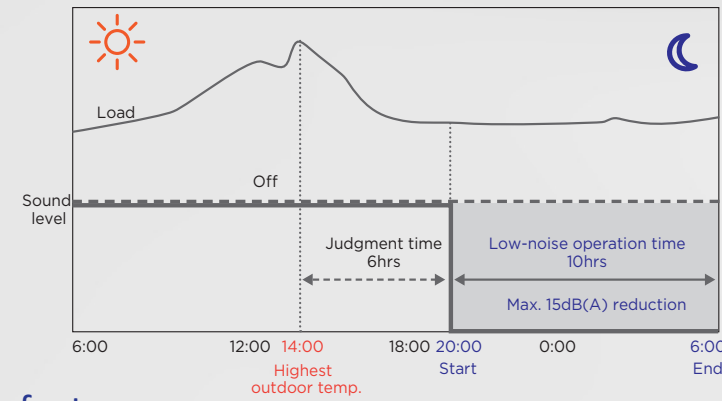

### Silent technology features

Several noise reducing components reduce the running noise of outdoor units.



### Precise temperature control

XMVF outdoor unit uses multiple and high precision EXVs to create comfortable indoor environment. The EXV control precision is up to 3000-stage which can precisely control refrigerant flow and guarantee stable indoor temperature. In this way, temperature setting can be adjusted in 0.5°C step, enabling precise comfort control.

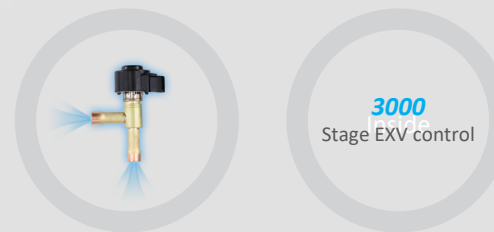

## COMPREHENSIVE CONTROL SOLUTIONS

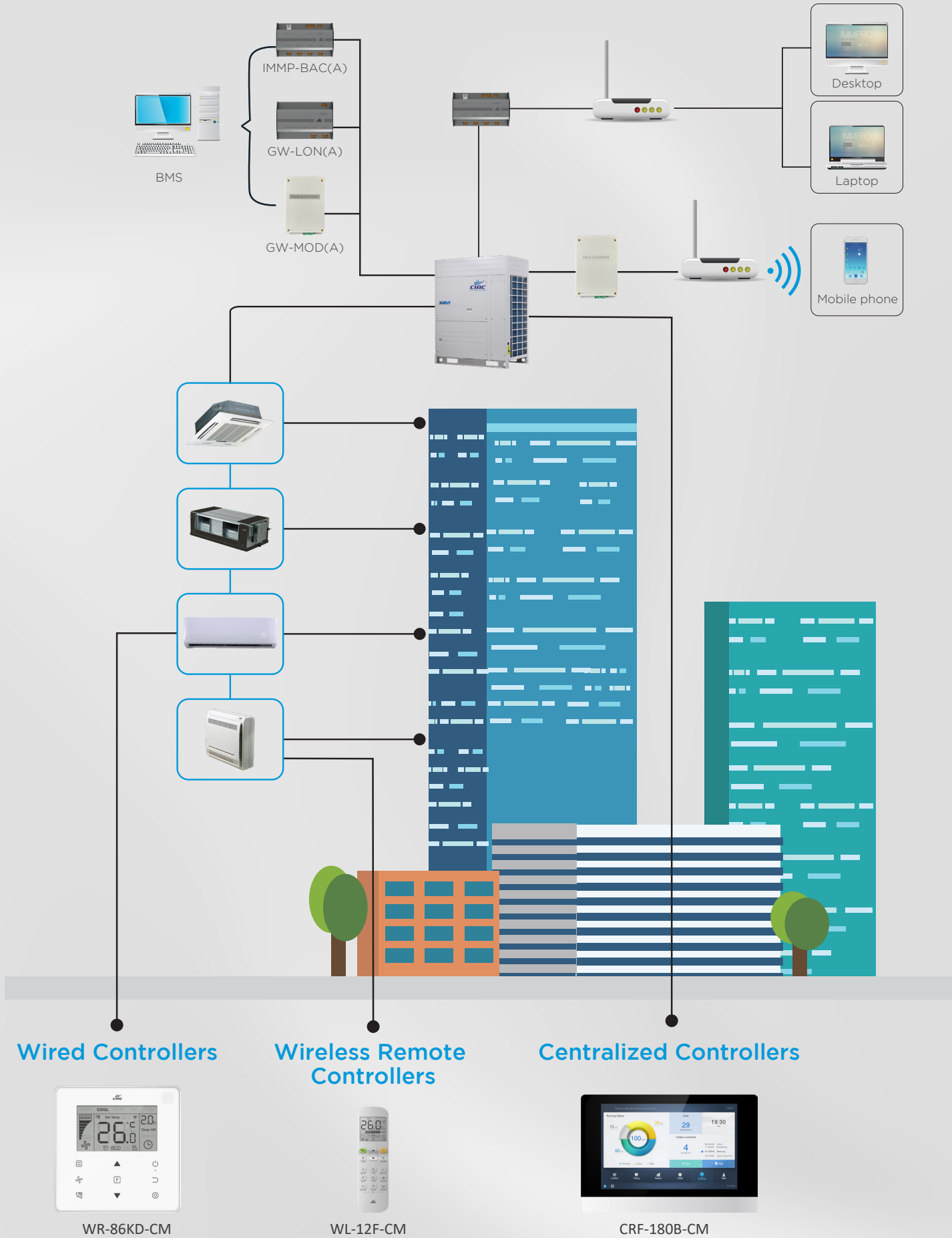

## SPECIFICATIONS

HP	8	10	12	14	16	18
<b>Model name</b>	CA400A-V0083VB1C	CA400A-V0103VB1C	CA400A-V0123VB1C	CA400A-V0143VB1C	CA400A-V0163VB1C	CA400A-V0183VB1C
<b>Power supply</b>	220V 3Ph~50/60HZ					
<b>Cooling<sup>1</sup></b>	Capacity	kW 22.4	kW 28.0	kW 33.5	kW 40.0	kW 45.0
		kBtu/h 76.5	kBtu/h 95.6	kBtu/h 114.4	kBtu/h 136.6	kBtu/h 153.7
	Power input	kW 5.25	kW 7.10	kW 8.90	kW 10.30	kW 12.00
	EER	4.27	3.94	3.76	3.88	3.75
<b>Connected indoor unit</b>	Total capacity	50-130%				
	Maximum quantity	13	16	20	23	26
<b>Compressor</b>	Type	DC Inverter				
	Quantity	1				
	Oil type	FV 50s				
	Start-up method	Soft start				
<b>Fan</b>	Type	DC				
	Quantity	1				
	Motor output	0.56				
	Static pressure	20(0.08) default;60(0.24) customization option				
<b>Refrigerant</b>	Airflow rate	10400(6121)		10800(6357)		11600(6828)
	Drive type	Direct				
	Type	R410A				
	Factory charge	kg(lbs) 8(17.6)				
<b>Pipe connections<sup>2</sup></b>	Liquid pipe	mm(inch) Φ12.7(1/2)		Φ12.7(1/2)		Φ15.9(5/8)
	Gas pipe	mm(inch) Φ25.4(1)		Φ28.6(1-1/8)		Φ31.8(1-1/4)
	Sound pressure level <sup>3</sup>	dB(A) 57		60		61
<b>Net dimensions (W×H×D)</b>	mm	960×1615×765		960×1615×765		1250×1615×765
	inch	37-13/16×63-9/16×30-1/8		37-13/16×63-9/16×30-1/8		49-1/4×63-9/16×30-1/8
	mm	1025×1790×830		1025×1790×830		1305×1790×820
<b>Packed dimensions (W×H×D)</b>	inch	40-3/8×70-1/2×32-11/16		40-3/8×70-1/2×32-11/16		51-3/8×70-1/2×32-1/4
	kg	193		200		296
	lbs	425		441		653
<b>Gross weight</b>	kg	209		216		313
	lbs	461		476		690
<b>Ambient temp.</b>	Cooling	*C(°F) -5(23) to 55(131)				

HP	20	22	24	26	28	30
<b>Model name</b>	CA400A-V0203VB1C	CA400A-V0223VB1C	CA400A-V0243VB1C	CA400A-V0263VB1C	CA400A-V0283VB1C	CA400A-V0303VB1C
<b>Power supply</b>	220V 3Ph~50/60HZ					
<b>Cooling<sup>1</sup></b>	Capacity	kW 56.0	kW 61.5	kW 67.0	kW 73.0	kW 78.5
		kBtu/h 191.3	kBtu/h 210.0	kBtu/h 228.8	kBtu/h 249.3	kBtu/h 268.1
	Power input	kW 16.50	kW 19.65	kW 20.10	kW 22.20	kW 24.18
	EER	3.39	3.13	3.33	3.29	3.25
<b>Connected indoor unit</b>	Total capacity	50-130%				
	Maximum quantity	33	36	39	43	46
<b>Compressor</b>	Type	DC Inverter				
	Quantity	2				
	Oil type	FV 50s				
	Start-up method	Soft start				
<b>Fan</b>	Type	DC				
	Quantity	2				
	Motor output	0.56×2				
	Static pressure	20(0.08) default;60(0.24) customization option				
<b>Refrigerant</b>	Airflow rate	12200(7181)		12200(7181)		19600(11536)
	Drive type	Direct				
	Type	R410A				
	Factory charge	kg(lbs) 13(28.7)				
<b>Pipe connections<sup>2</sup></b>	Liquid pipe	mm(inch) Φ15.9(5/8)		Φ19.1(3/4)		Φ19.1(3/4)
	Gas pipe	mm(inch) Φ31.8(1-1/4)		Φ31.8(1-1/4)		Φ34.9(1-3/8)
	Sound pressure level <sup>3</sup>	dB(A) 63		64		64
<b>Net dimensions (W×H×D)</b>	mm	1250×1615×765		1585×1615×765		1585×1615×765
	inch	49-1/4×63-9/16×30-1/8		62-3/8×63-9/16×30-1/8		62-3/8×63-9/16×30-1/8
	mm	1305×1790×820		1305×1790×820		1650×1810×840
<b>Packed dimensions (W×H×D)</b>	inch	51-3/8×70-1/2×32-1/4		64-15/160×71-1/4×33-1/16		64-15/160×71-1/4×33-1/16
	kg	296		352		352
	lbs	653		776		776
<b>Gross weight</b>	kg	313		376		376
	lbs	690		829		829
<b>Ambient temp.</b>	Cooling	*C(°F) -5(23) to 55(131)				

Notes:  
 1. Indoor temperature 27°C DB, 19°C WB; outdoor temperature 35°C DB; equivalent refrigerant piping length 7.5m with zero level difference.  
 2. Diameters given are those of the unit's accessories.  
 3. Sound pressure level is measured at a position 1m in front of the unit and 1.3m above the floor in a semi-anechoic chamber.  
 Product specifications change from time to time as product improvements and developments are released and may vary from those in this document.



## CIAC XMVF VRF 8-90HP Cooling Only Series





## ENERGY SAVING

### Energy Management System (EMS)

- Floating refrigerant temperature to balance comfort and efficiency**

The evaporating temperature is automatically adjusted according to both indoor and outdoor temperature to maximize the comfort and energy efficiency.

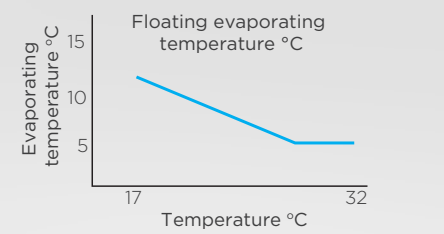

- Output limitation during electricity supply restrictions**

With the integration of EMS, for projects with temporary electricity supply restrictions, XMVF VRF can be set to output 40-100% capacity.

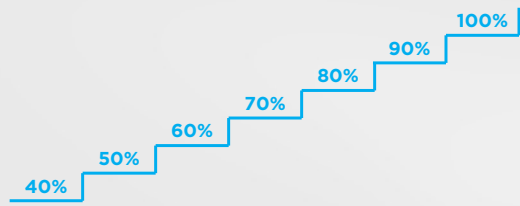

### 4-side heat exchanger

G-type heat exchangers have higher energy efficiency than the U-type.

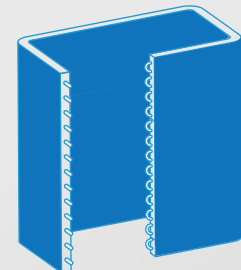

2-rows G-type heat exchanger

### High efficiency “2-1” refrigerant flow

The high efficiency “2-1” refrigerant flow increases the proportion of liquid refrigerant in heat exchanger and improve heat exchange efficiency.

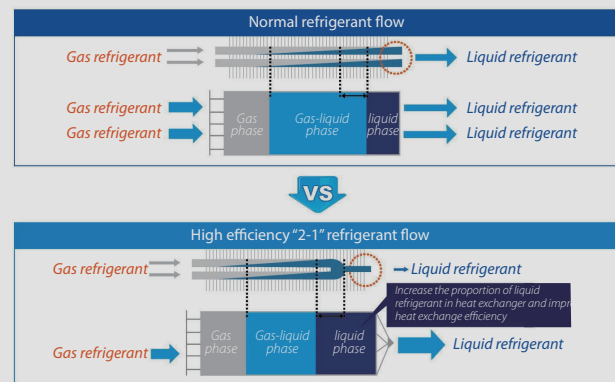

2

## WIDE APPLICATION RANGE

### Wide Capacity Range

For single unit, the footprint is small and maximum capacity is up to 30HP. For combined units, maximum three 30HP units can be combined with capacity up to 90HP.



### Wide Operation Rang

The XMVF VRF can operate stably in a wide ambient temperature range: from -5°C to 55°C in cooling mode.

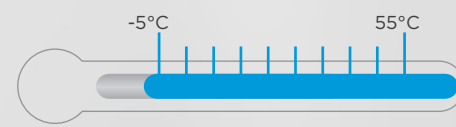

### Long Piping Capability

- Total piping length: 1000m
- Longest piping length-actual (equivalent): 175m(200m)
- Longest piping length after first branch: 40/90\*<sup>m</sup>
- Level difference between IDUs and ODU-ODU above (below): 90m (110m)
- Level difference between IDUs: 30m

\*The longest length after 1st branch is 40m as standard but can be extended up to 90m under certain conditions. Please contact your local dealer for further information

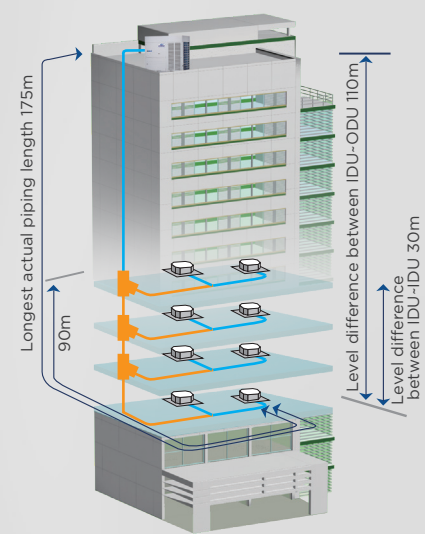

### Selectable ESP of outdoor unit\*

Selectable external static pressure of outdoor unit: 0Pa, 20Pa, 40Pa, 60 Pa which can meet most of installation requirements.

\*This function is available as a customization option.



3

## HIGH RELIABILITY

### Real-time Refrigerant Amount Monitoring

The temperature and pressure of refrigerant can be real-time monitored by the outdoor unit. When the level of refrigerant is too low or too high, it can cause damage to the unit and poor performance. XMVF outdoor unit can detect excessive or insufficient amounts of refrigerant to ensure consistent performance.

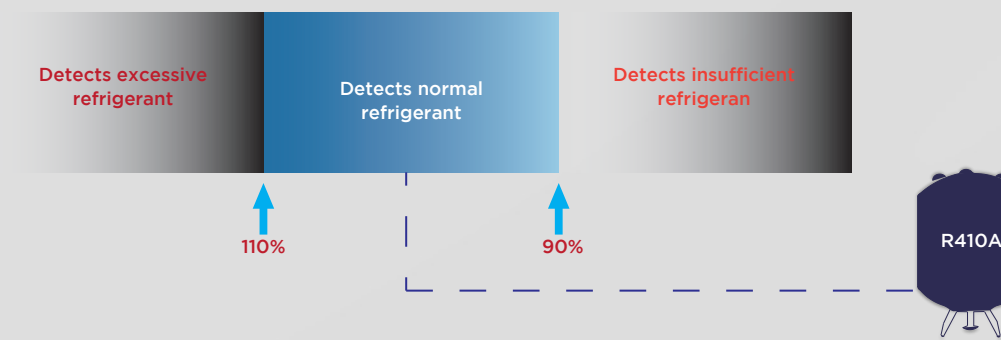

### Duty Cycling

Duty cycling equalizes the running time of the outdoor units in a multiple-unit system and of the compressors in each unit, significantly extending compressor lifespan.



### Backup Operation

In units with two compressors, if one compressor fails, the other compressor can run on its own for up to 4 days, allowing time for maintenance or repair whilst maintaining comfort.

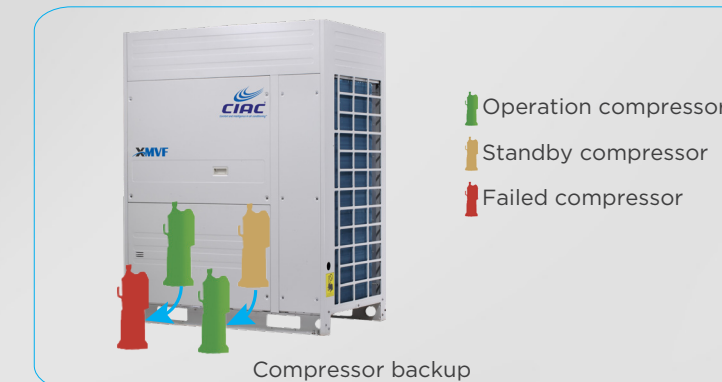

4

## HIGH RELIABILITY

### Refrigerant cooling PCB

The XMVF VRF uses refrigerant cooling technology to cool the electric control box. It decreases the average temperature of electrical control components by about 8 degrees, guaranteeing the stable and safe running of the control system.

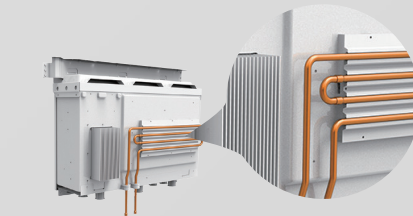

### Intelligent Configurations

Intelligent configurations greatly simplify installation, commissioning and servicing.

- Field local configuration achieves quick and easy on-site settings, simplifies installation and commissioning.
- System checking and settings also can be easily achieved via wired controller making the configuration more flexible and convenient.
- A desktop or laptop PC can be used for browser-based access to achieve system configurations through IMMPRO gateway via a LAN connection.



### Automatic Refrigerant Charging

Automatic refrigerant charging makes installation and service easier and more efficient.

\*This function is available as a customization option.



### Dust-clean function\*

The innovatively designed dust-clean function enables the outdoor unit to prevent the dust by itself.

\*This function is available as a customization option.



5