



DKM-500B_J

CRESCENT CUBER ICE MACHINE AND DISPENSER SERENITY SERIES



DKM-500B_J
08/03/23
Item # 13157

Item #: _____
Project: _____
Qty: _____
AIA#: _____

Features

- ▶ Individual crescent cube
- ▶ Stainless steel evaporator
- ▶ CycleSaver™ design 

- Up to 545 lbs. of ice production per 24 hours
- Built-in insulated polyethylene bin has a storage capacity of 6.7ft³/200 lbs.*
- Durable, attractive one piece stainless steel exterior
- One piece design allows for easy installation and serviceability
- Self-contained design reduces opportunities for cross contamination
- Protected by H-GUARD Plus  Antimicrobial Agent
- Push button operated; dispenses 13 lbs. of ice per minute
- 6" flanged legs are standard, Optional 6" casters available
- 11 ft. power cord with NEMA 5-20P Plug
- R-404A Refrigerant

Warranty:

3 Year Parts & Labor on entire machine. 5 Year Parts & Labor on Evaporator. 5 Year Parts on Compressor; air-cooled condenser coil. Valid in United States, Canada, Puerto Rico and U.S. Territories. Contact factory for warranty in other countries.

*Rated in accordance with AHRI Standard 820(I-P). Capacity based on 100% of total volume x 30 lb/ft³ average density of ice.

W x D x H
30" x 28" x 77"*

*including 6" legs
(or optional casters)

Shipping Dimensions
35³/₄" x 35" x 83"

 ADA Compliant



KM|EDGE™

DKM-500BAJ ★
Air-Cooled

DKM-500BWJ
Water-Cooled



ICE PRODUCTION WATER USAGE ELECTRICAL

Condenser	Model	Air / Water Temp Lbs. per 24 hours		Potable Gal. per 100 lbs.	Condenser Gal. per 100 lbs.	kWh Used per 100 lbs.	Min. Circuit/Max. Fuse Size	Amperage	Voltage	Heat Rejection BTU/hr.	Refrigerant Charge Amount	Net / Ship Weight (lbs.)
		70°/50°F	90°/70°F	90°/70°F	90°/70°F	90°/70°F						
Air-Cooled	DKM-500BAJ	545	534	16.6	N/A	5.56	20A	13.5A	115V/60/1	9,100	1 lb. 12.2 oz.	385 / 300
Water-Cooled	DKM-500BWJ	540	500	18.0	103	4.79	20A	12A	115V/60/1	7,700	1 lb. 2 oz.	347 / 310

KMEdge™ Cube Dimensions*

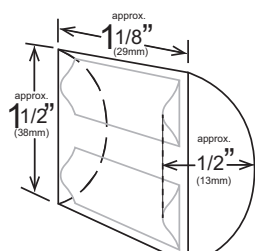

* approximate size in inches, image not to scale

Operating Limits

- Ambient Temp Range 45 - 100°F
- Water Temp Range 45 - 90°F
- Water Pressure 10 - 113 PSIG
- Voltage Range 104 - 127V
- If GFCI is required, a GFCI breaker MUST be used in lieu of GFCI receptacle

Service

- Allow at least 12" (30 cm) clearance on the left side and 6" (15 cm) clearance on the right side, rear and top.

Plumbing

- Icemaker Water Supply Line: Min. 1/4" Nominal ID Copper Water Tubing or Equivalent
- Icemaker Drain Line: Min. 3/4" Nominal ID Hard Pipe or Equivalent
- Water-Cooled Model (Lines Must Be Independent of Icemaker)
- Condenser Water Supply Line: Min. 1/4" Nominal ID Copper Water Tubing or Equivalent
- Condenser Drain/Return Line: Min. 1/4" Nominal ID Hard Pipe (open drain system) or Copper Water Tubing (closed loop system) or Equivalent

Water Filter

Please refer to water filter specification sheet for recommendations.

Hoshizaki reserves the right to change specifications without notice.



DKM-500B_J

CRESCENT CUBER ICE MACHINE AND DISPENSER
SERENITY SERIES



DKM-500B_J
08/03/23
Item # 13157

FRONT VIEW

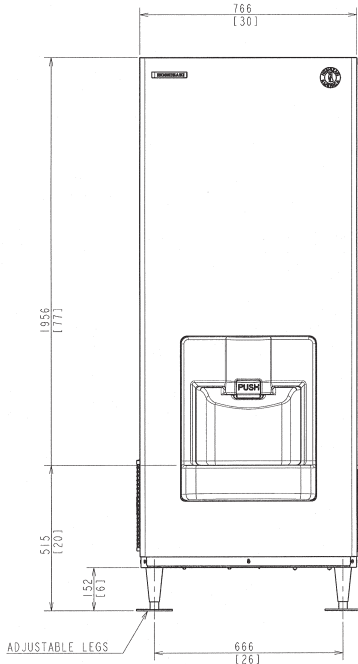

AIR-COOLED

REAR VIEW

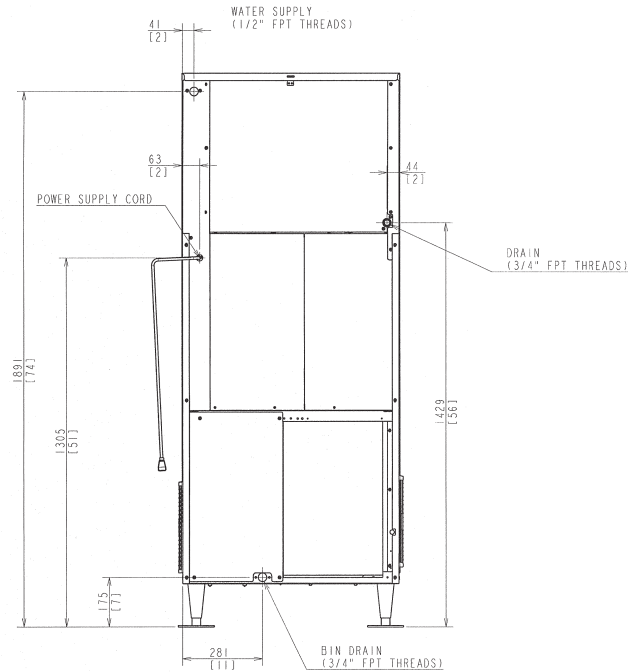

AIR-COOLED

SIDE VIEW

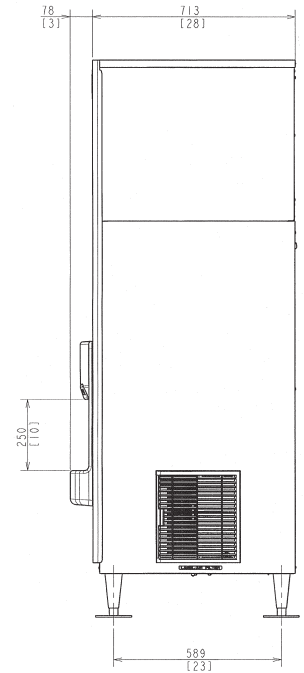

AIR-COOLED

FRONT VIEW

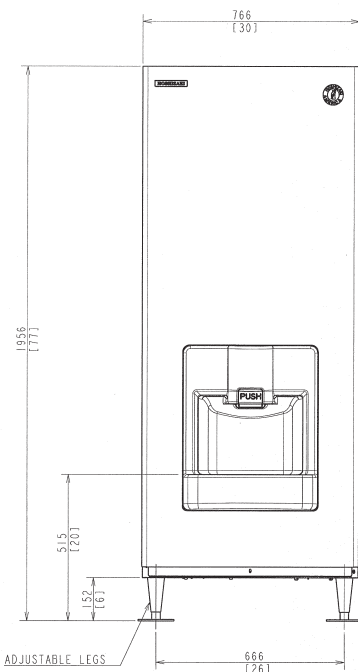

WATER-COOLED

REAR VIEW

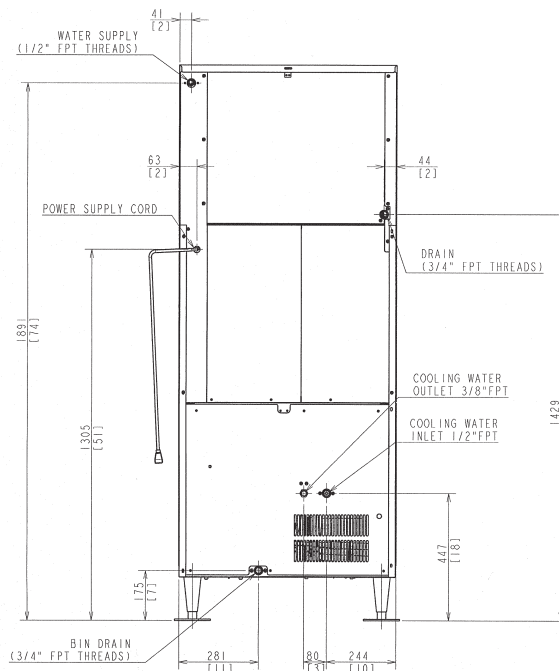

WATER-COOLED

SIDE VIEW

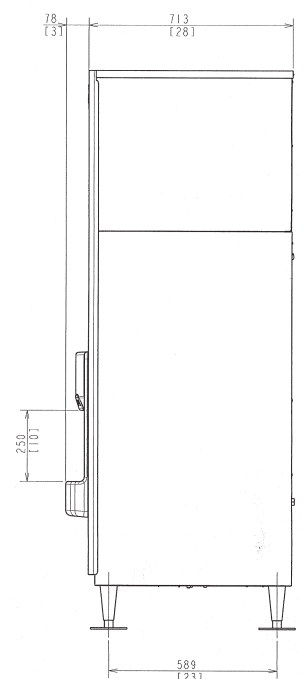

WATER-COOLED